

Delta Transducers

Model : ARI731



Features & Application

Micro sensor, small shape, stress area is large, the stainless steel material. Apply to all sorts of small space load.

Widely used in industrial development in the areas of measurement and control.

Mounting Dimension

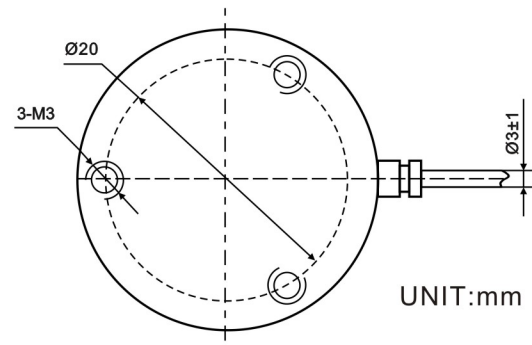
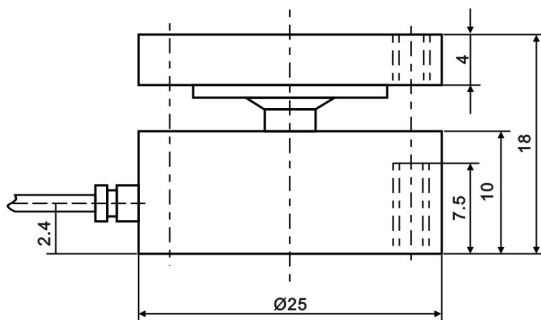

UNIT:mm

Load Direction

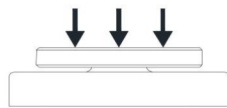

Wiring

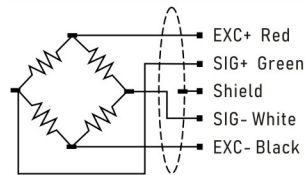

Technical Parameters

Specifications	Technique
Rated load	20, 30, 50, 100, 200, 300, 500, 1000, 2000 kg
Comprehensive error	$\leq \pm 0.2\%$
Non-linearity	0.2%
Rated output	$1.5 \pm 20\% \text{mV/V}$
Creep	$\pm 0.1\% \text{F.S.} / 30\text{min.}$
Zero balance	$\pm 1.0\% \text{F.S.}$
Input resistance	800~1100 Ω
Output resistance	800~1100 Ω
Insulation resistance	$\geq 5000 \text{M}\Omega / 100\text{VDC}$
Temp.effect on span	$\pm 0.05\% \text{F.S.} / 10^\circ\text{C}$
Temp.effect on zero	$\pm 0.05\% \text{F.S.} / 10^\circ\text{C}$
Compensated temp range	-10~60 $^\circ\text{C}$
Use temp range	-20~80 $^\circ\text{C}$
Excitation voltage	5~12V
Safe overload	150%F.S.
Ultimate overload	200%F.S.
Defend grade	IP67