

Delta Transducers

Model : SRRK

Features & Application



Compact structure, high comprehensive precision, good long-term stability, high quality alloy steel surface nickel plating.
The peld of large value testing machine, standard dynamometer, pressure testing instrument, automation equipment and testing peld.

Mounting Dimension

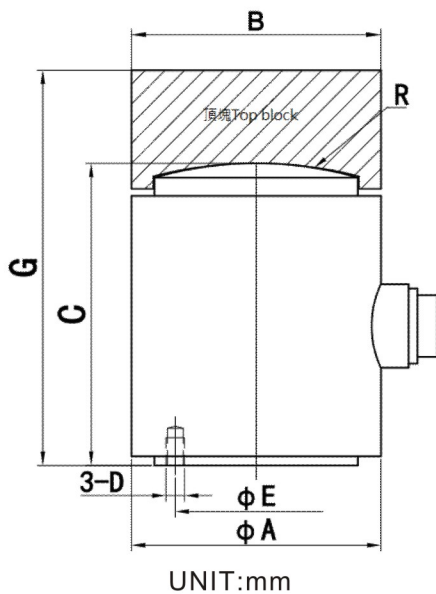

CAP (T)	30-50	60-100	200	300	500	700-1000
φA	78	98	128	154	196	246
φB	78	98	128	154	196	246
C	100	110	140	170	220	282
D	M6	M6	M6	M8	M10	M6
E	55	75	100	120	150	190
R	100	120	200	300	400	500
G	125	140	180	215	275	352

Load Direction

顶部壓帽配送 Top cap delivery

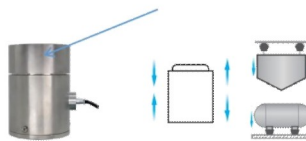

Wiring

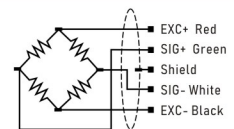

Technical Parameters

Specifications	Technique
Capacity	2、 20、 30、 50、 60、 100、 200、 300、 500、 700、 1000 T
Rated Output	2.0/3.0±10% mV/V
Zero Balance	±2% F.S.
Non-linearity	0.3% F.S.
Hysteresis	0.1% F.S.
Non-repeatability	0.1% F.S.
Creep (30min)	0.05% F.S.
Safe Overload	150%
Ultimate Overload	200%
Operating Temp.	-20~80°C
Temp. Shift Zero	0.05% F.S. / 10°C
Temp. Shift Span	0.05% F.S. / 10°C
Response Frequency	10kHz
Impedance	700Ω
Range Excitation	5~15V
Insulation Resistance	>5000MΩ / 100VDC
Cable	Ø5 X 3m