

Rated Load (klb)	A	B	C	D	E	F	G	H	I	J
10~25	17.3	42.9	49.3	196.9	165.1	125.1	19.1	22.9	41.4	43.2
40	21	49.3	62	260.4	215.9	162.4	25.4	28.5	50.8	53.3
50~75	27	62	74.7	260.4	215.9	162.4	25.4	34.8	64.5	67.3
100~125	41	73.6	98	387.4	323.8	228.4	38.1	45.7	83.8	87.1

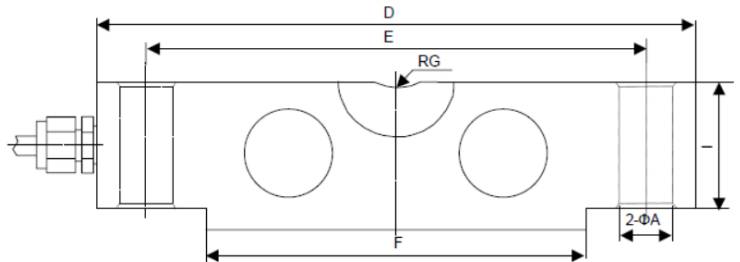

TECHNICAL PARAMETER

Exc+(Red); Exc-(Black); Sig+(Green); Sig-(White);

Rated load	10,20,25,40,50,60,75,100,125klb	Insulation resistance	≥5000MΩ
Accuracy class	0.05	Nominal Temp Range	-10℃ ~ +40℃
Sensitivity	3.0±0.003mV/V	Service Temp Range	-30℃ ~ +70℃
Non-linearity	±0.05%F.S	Safe load limit	150%F.S
Hysteresis error	±0.05%F.S	Breaking load	200%F.S
Creep error(30min)	±0.03%F.S	Nominal of range excitation	10~12 VDC
TC ZERO	±0.02F.S/10℃	Protection Class	IP67
TC SPAN	±0.02F.S/10℃	Material	Alloy Steel
Input resistance	750±10Ω	Cable Length	12m(10~40klb)
Output resistance	702±5Ω		16m(50~125klb)



Rated Load (klb)	A	B	C	D	E	F	H	J	K	L	M
10~25	168	254	190.5	203	203	152	20	152	19	19	20
40	198	355.6	292.1	254	203	190.5	28.5	152	19	22.7	20
50~75	241.3	355.6	292.1	254	228.6	190.5	28.5	165	25.4	22.8	28.5

